



BINGHAMTON
UNIVERSITY
STATE UNIVERSITY OF NEW YORK

STATE of THE
PRESIDENT HARVEY G. STENGER SEPTEMBER 25, 2018
UNIVERSITY

Meeting of the Full Faculty
October 23, 2018

A growing campus

- Approximate enrollment of 17,720
 - 13,975 undergraduate — up 318 from 2017–18
 - 3,745 graduate — up 154 from 2017–18
 - Total increase of 472
- Impact of recent state investments
 - Increased University expenditures to over \$783 million (compared to \$650 million in 2012–13)
 - Increased enrollment by 2,700 students
 - Increased faculty and staff by 450
 - University's economic impact now over \$1.5 billion

The Class of 2022 (new undergraduates)

- 4,019 freshman and transfer students
- 1370 average SAT score



School of Pharmacy and Pharmaceutical Sciences

- Interprofessional, patient-centered care and research
- Clinical partnerships with local hospitals and healthcare providers
- Doctor of Pharmacy program granted Candidate status
- \$60-million facility opened August 2018
 - Simulator patients
 - Community pharmacy
 - Robotic dispenser
 - Sterile compounding room



The Health Sciences Campus

- New home for Decker School of Nursing and Health Sciences
 - New programs in physical therapy, occupational therapy, speech therapy, audiology therapy
 - \$30 million renovation
 - \$15.9 million research and development facility in design phase
 - \$1.2 million donor-supported elder-care facility
 - \$130 million in private investments in neighborhood



Architect's rendering

New facilities for research and entrepreneurship

- Smart Energy Building opened August 2017
 - New home for physics and chemistry departments
 - Cutting-edge energy research: thin-film panel design, solar cells, next-generation battery production
- Koffman Southern Tier Incubator opened June 2017
 - Added clean-energy incubator April 2018
 - 90 percent occupation rate
 - 40 emerging firms
 - Links to University research and graduate programs



Improving the campus

- Science 4 renovations
 - New elevators, offices and laboratories
 - Changes to exterior walls, heating and cooling systems save energy
 - Similar improvements pending for Science 1 and 2
- Safety and communications enhancements
 - Increased emergency training for staff and student advisors
 - B-Alert system changed to opt-out
 - Added 160 security cameras and 60 panic buttons
 - Improved cellphone reception
 - Three additional counselors hired

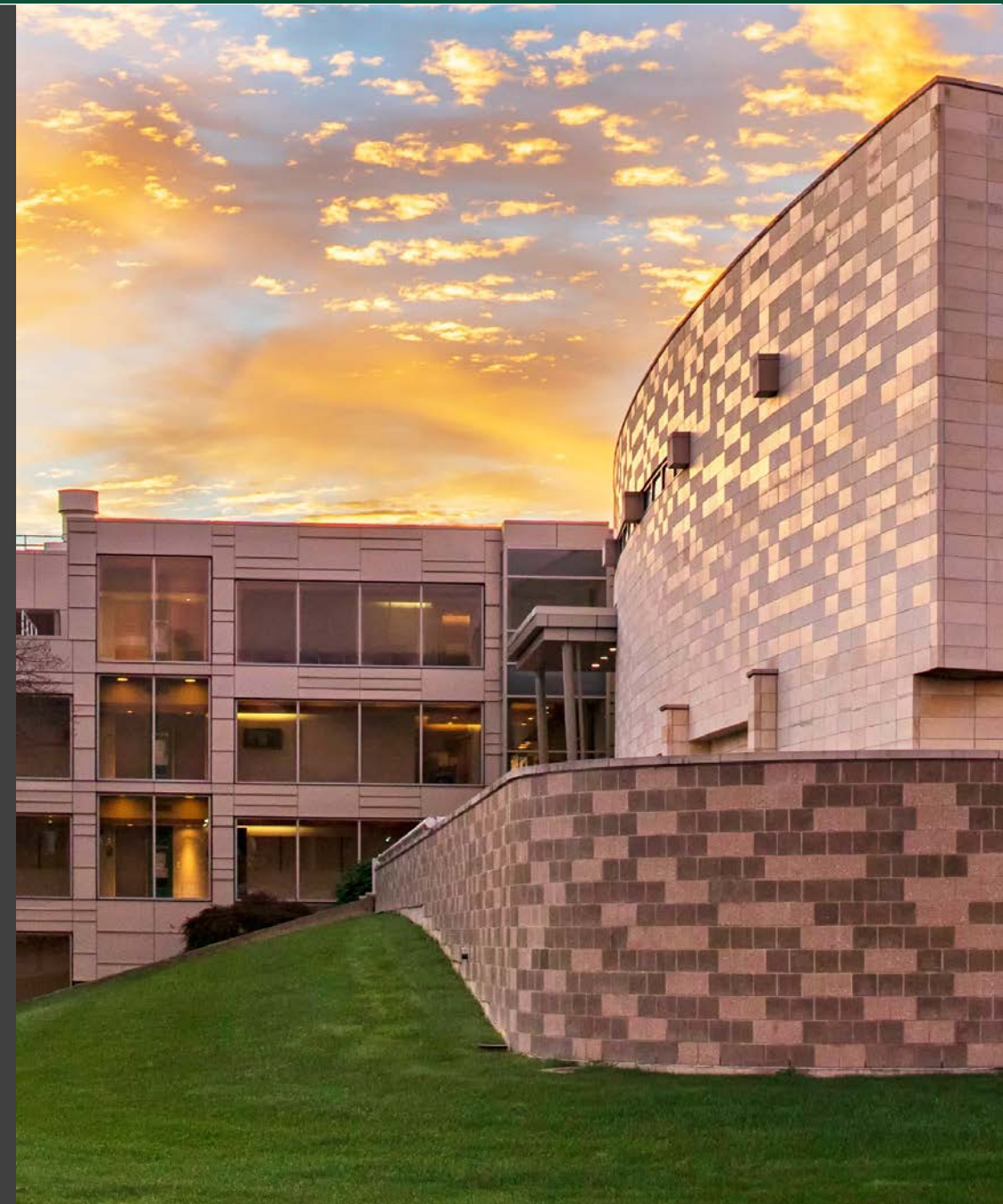

Renewing faculty and staff

- Hiring initiative increased faculty to 600 in 2017–18
- 61 faculty searches for 2018
 - Melissa Sutherland, professor of nursing, member of American Academy of Nursing, focus on global health
 - Chandiren Valayden, assistant professor of human development, examining racism and human rights
 - Fuda Ning, assistant professor of systems science and industrial engineering, researching 3D printing of metals and composites
 - David Sterling Brown, assistant professor of English, teaching issues of race in Shakespearean literature
- Hired 160 new full-time staff

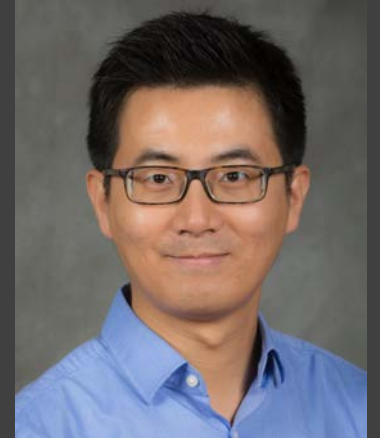



Increasing scholarship and research

- 2017–18 research expenditures nearly \$47.5 million, up 19.2 percent from previous year
- \$224 million in research proposals submitted
- Awarded \$57.6 million (committed funds)
- SOPPS research awarded funds of \$3.3 million in first two years
- Excellence in STEM research:
 - Biomedical engineering professor Kaiming Ye — \$5 million National Institute of Standards and Technology (NIST) grant for advances in biofabrication
 - Physics faculty Louis Piper and Wei-Cheng Lee — \$2 million Department of Defense (DOD) grant examining biological systems in computing

Recognition across the campus

- History professor Anne C. Bailey praised for her book *The Weeping Time: Memory and the Largest Slave Auction in American History*
- Associate Professor of Health and Wellness Lina Begdache, examining the connection between diet and emotional well-being
- School of Management Assistant Professor Scott Bentley: CEO pay impacts employee layoffs; and Assistant Professor Chou-Yu Tsai: “compassionate” leadership styles increase worker productivity
- English professor Liz Rosenberg publishes affecting biography of L. M. Montgomery
- Center for Medieval and Renaissance Studies (CEMERS) publishes *Reconsidering Boccaccio: Medieval Contexts and Global Intertexts*

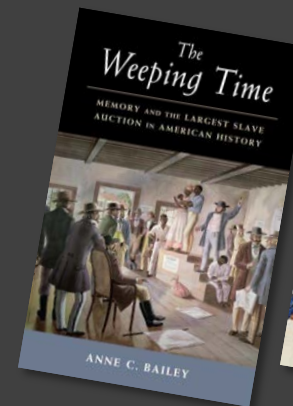

Collaborative research: the TAEs

- 180 Binghamton faculty participating in Transdisciplinary Areas of Excellence (TAEs)
- 96 TAE faculty hires (2013–19)
- TAE core and affiliated faculty have generated \$17 million in external funding
- \$950,000 in seed grants have generated \$4 million in external funding
- New TAE in Data Science
 - Utilizing advanced techniques to gather and interpret data, and address significant societal problems
 - Collaborative research and scholarship involving faculty from diverse fields across campus



Salary increases and fiscal challenges

- Professional and classified staff receive salary increases
 - Raises are retroactive to 2016–17
 - Significant lump-sum payments
 - Increases are not funded by the state
- Cost to campus:
 - Approximately \$10 million in 2018–19
 - Recurring cost of over \$4 million/year
- Reserves will be used to cover retroactive, first-year increases
 - Expect increases in enrollment, tuition and student fees
 - Long-term solutions must come from partnership between us and Albany
- We will continue to invest in programs and initiatives that will grow resources



University initiatives

■ **Presidential Post-Doctoral Fellowships**

- First cohort on campus
- Received \$332,000 SUNY matching funds
- 2-year program with optional third year (depending on program)

■ **Data Science Initiative**

- TAE established
- Instrumentation purchases
- Team identifies scope and range of research
- Seed grants and seminars underway

■ **Health Sciences Campus**

- Construction ongoing
- New program proposals submitted

■ **Health Sciences Core**

- Located in Center of Excellence
- Manager hired
- Seeking funding for equipment purchases, including functional magnetic resonance imaging (fMRI)

Advancing the University

- \$13.3 million raised 2017–18
 - \$10.7 million cash gifts
- Now preparing third comprehensive gifts campaign
 - Working goal of \$150 million over 7 years
 - Second year of silent phase
 - \$35 million raised
 - Expected annual support of \$15–20 million over course of campaign
- Improved rankings
 - According to *U.S. News & World Report* (2019), Binghamton is the #80 best university in the nation, and #32 best public university





Thank you!

Email: hstenger@binghamton.edu

