

BINGHAMTON UNIVERSITY

BIOTECHNOLOGY BLDG (INOVATIVE TECHNOLOGIES COMPLEX)

BLDG. NO. 136

BASEMENT FLOOR PLAN

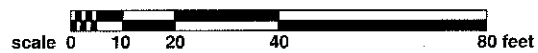

02/11

Gross Area: 28,390 sf



BINGHAMTON UNIVERSITY

BIOTECHNOLOGY BLDG (INOVATIVE TECHNOLOGIES COMPLEX)

BLDG. NO. 136

FIRST FLOOR PLAN

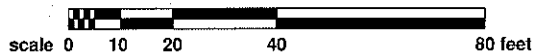

02/11

Gross Area: 43,249 sf



BINGHAMTON UNIVERSITY

BIOTECHNOLOGY BLDG (INOVATIVE TECHNOLOGIES COMPLEX)

BLDG. NO. 136

SECOND FLOOR PLAN



02/11

Gross Area: 43,271 sf

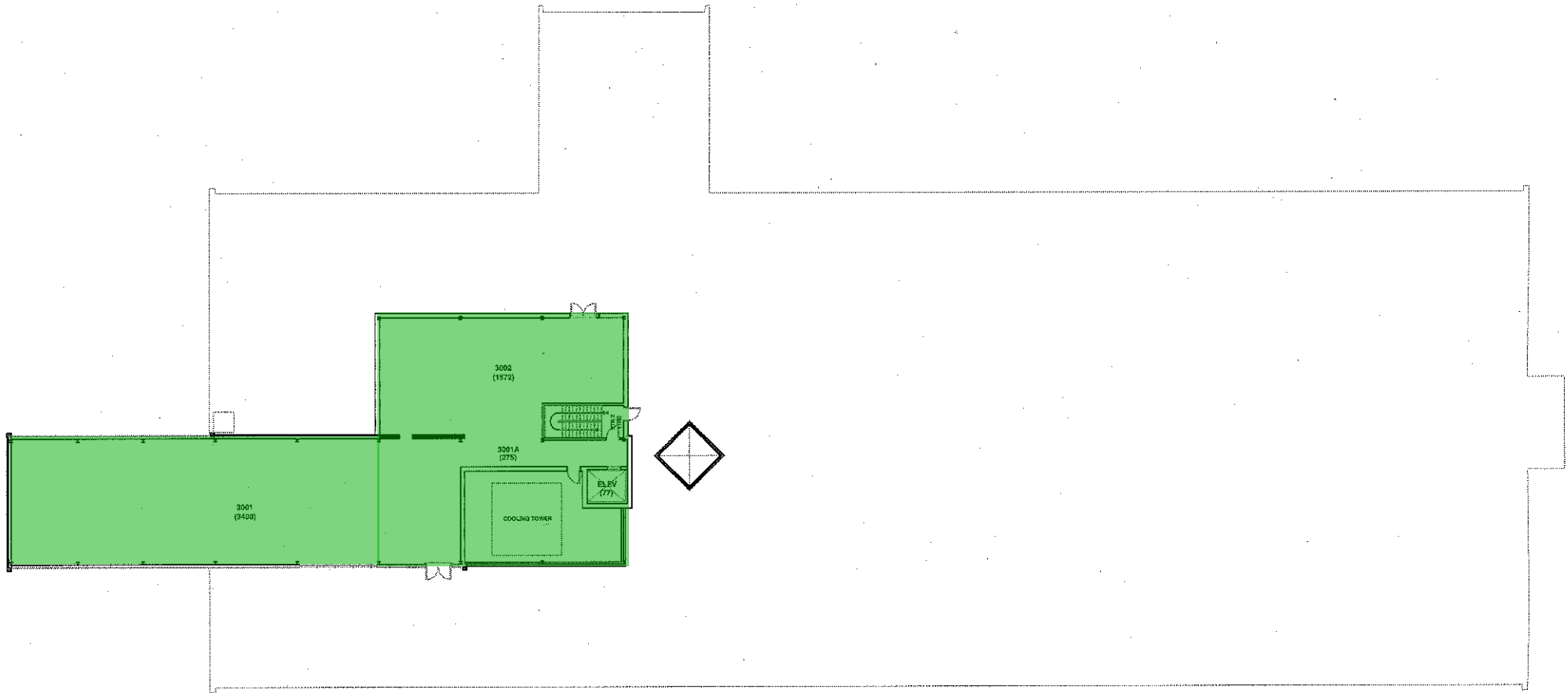

BINGHAMTON UNIVERSITY
BIOTECHNOLOGY BLDG (INOVATIVE TECHNOLOGIES COMPLEX)
THIRD FLOOR PLAN

BLDG. NO. 136

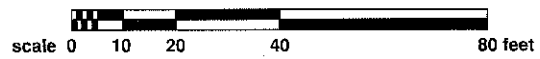

04/08

Gross Area: 5,886 sf